

The benefits of Moderra™

Attractive

Available in a wide variety of textures and colors, Moderra has the design appeal and aesthetic versatility you require.

Durable

Moderra's segmental concrete unit design is resistant to the factors that damage or deface most other types of enclosures.

- Natural elements (wind, snow, hail)
- Equipment (mowers, string trimmers, snow blowers)
- Aging (twisting, bending, rusting)
- Animals (burrowing, nesting)

Versatile

Moderra can be easily installed on new or existing decks.

Easy to Install

The combination of lightweight units and patented H-Channel technology allows for a fast and easy installation.



Getting started

Tools needed

- Safety Glasses
- Chisel
- Tamper
- String
- Power Drill
- Gloves
- Shovel
- Rubber Hammer
- Level
- Stakes
- Concrete adhesive

Materials needed

Easily calculate your Moderra material requirements for each side of the deck you plan to enclose.

40"	20	4	39	8	58	12	76	15	95	19	114	23
	2	1	4	1	5	2	7	2	8	3	10	3
32"	16	4	31	8	46	12	61	15	76	19	91	23
	2	1	3	1	4	2	6	2	7	3	8	3
24"	13	4	24	8	35	12	46	15	58	19	69	23
	2	1	2	1	3	2	4	2	5	3	6	3
16"	9	4	16	8	24	12	31	15	39	19	46	23
	1	1	2	1	2	2	3	2	4	3	4	3
8"	5	4	9	8	13	12	16	15	20	10	24	23
	1	1	1	1	2	2	2	2	2	3	2	3
			5'	10'	15'	20'	25'	30'				

Deck Length

Moderra Units (#) →	39	8	← Bracket (#)
H-Channel (#) →	4	1	← Starter Ledge (#)



A Division of Alliance Concrete Concepts, Inc.
325 Alliance Place ■ Rochester, MN 55906

Toll Free: 1-877-248-7456
Fax: 507-529-2879
www.moderra.com
e-mail: info@moderra.com

©2004 Alliance Concrete Concepts Inc. Moderra Concrete Siding and the Moderra Concrete Siding logo are trademarks of Alliance Concrete Concepts, Inc. U.S. Patent No. 6,374,552. Other applicable patents issued and pending. 09/04

Masonry made easy™... and built by you!

Concrete Deck Enclosure



Decking has never looked this good!



You'll be amazed how easy it is to make an ordinary deck extraordinary!



Moderra™ Components



8" Block
 Size..... 8" H x 16"W x 2.5"D
 Weight..... 25 lbs.
 Area 0.889 sq.ft.



8" Corner Block
 Size..... 8" H x 8"W x 2.5"D
 Weight..... 22 lbs.
 Area 0.889 sq.ft.



4" Sill Block
 Size..... 4" H x 16"W x 4.5"D
 Weight..... 18 lbs.
 Area 0.445 sq.ft.

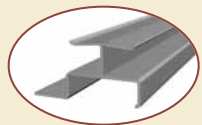

H-Channel
 Material Aluminum
 Weight..... 4.32 lbs.
 Length..... 8 ft.

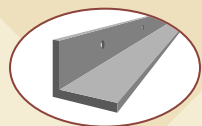

Starter Ledge
 Material Pre-drilled Steel
 Size..... 2"H x 3"W x .25"D
 Weight..... 41 lbs.
 Length..... 10 ft.



Deck Bracket
 Material Galvanized Steel



Deck Vent
 Material Plastic
 Dimensions 8"H x 16"W



Super-Stik™
 Weight..... 29 oz.

Assembles in a snap...

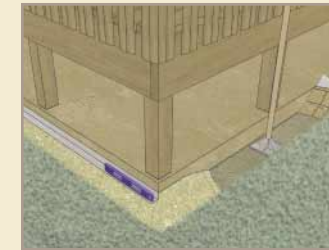

STEP 1 Start at the lowest corner of the Deck. Dig a trench, fill with gravel, and compact with tamper. Position and level the Starter Ledge.

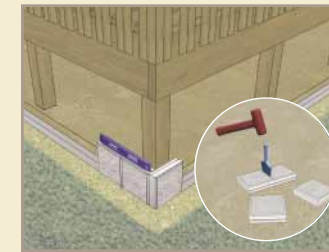

STEP 2 The first corner consists of a full width unit, and an 8" long unit. Split a full width unit to make the 8" long unit.

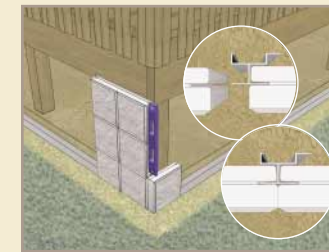

STEP 3 Place one unit on top of another. Check to ensure column is straight and level. Place H-Channel in the groves on the side of the units once column is complete.

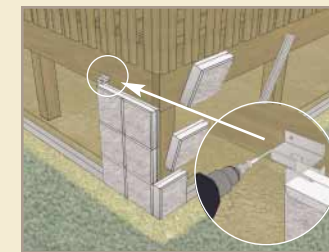

STEP 4 Place bracket in the slot on the backside of the H-Channel. Screw bracket into the deck. Continue building additional columns,

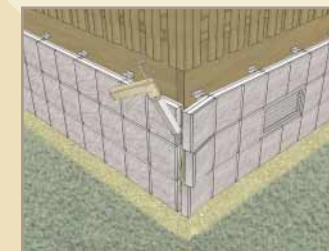

STEP 5 Substitute a vent for a full unit to allow for air movement. Glue corners together when last column is finished.



STEP 6 Finish the Moderra enclosure by installing sills with glue. Landscape around enclosure when finished.